

# 21

promises of the  
ultimate conference,  
meeting or event.  
One of a kind.

QHOTELS

Crewe Hall

Crewe, Cheshire

One of 21 outstanding QHotels.



Hotel Group of the Year  
2008 - 2009





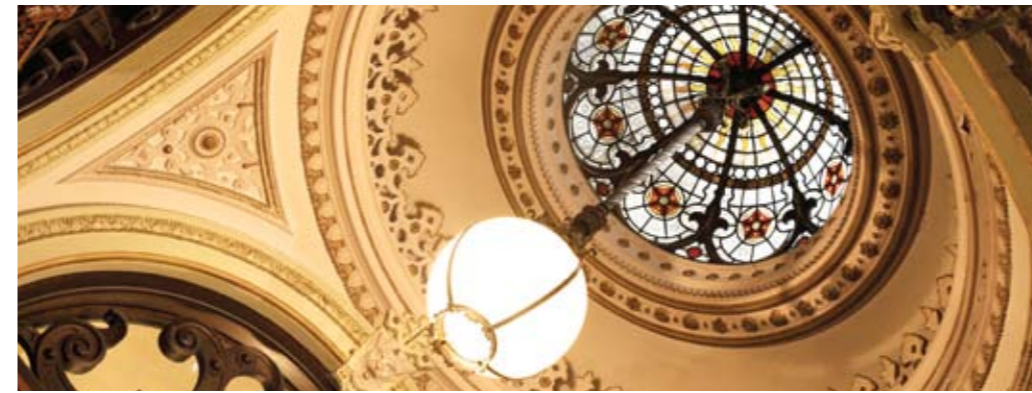

# 394

years impressing  
the great and the good.

The historic and majestic Crewe Hall is a hotel that's quite literally, fit for a king. In its former life as the ancestral home of the Crewe family, this Grade I listed Jacobean mansion has welcomed King George V, Queen Mary and Queen Elizabeth II through its gates. Not to mention a plethora of pop stars, politicians and business tycoons. Since then, we've invested the princely sum of £13.5 million building a huge, state-of-the-art Events Centre within its grounds. And there are still 8 acres of beautiful parkland and gardens left to explore. With its unique blend of period splendour, ultra-modern comforts and conveniences, Crewe Hall is truly one of a kind.





# 17,000

delegates treated like royalty last year.

With a location that's as accessible as it is beautiful (just off the M6), meeting rooms that are as functional as they are inspirational, and a service that's as professional as it is personal, Crewe Hall is the perfect place to mix business and pleasure. There are 17 conference rooms in all, ranging from the distinctly historic to the unmistakably modern. From the Long Gallery – used in Jacobean times for games, dancing and exercising, to our high-tech, purpose-built suites in our new Events Centre. What's more, each room can be tailored to suit your particular needs. Whether it's a corporate banquet, product launch, annual conference, or whatever else you care to dream up, our dedicated Event Planners have the experience and expertise to make it happen.

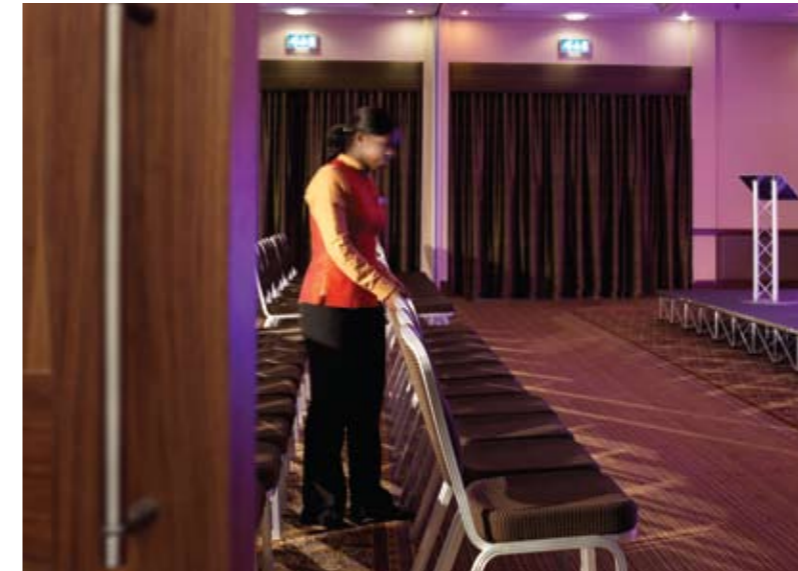
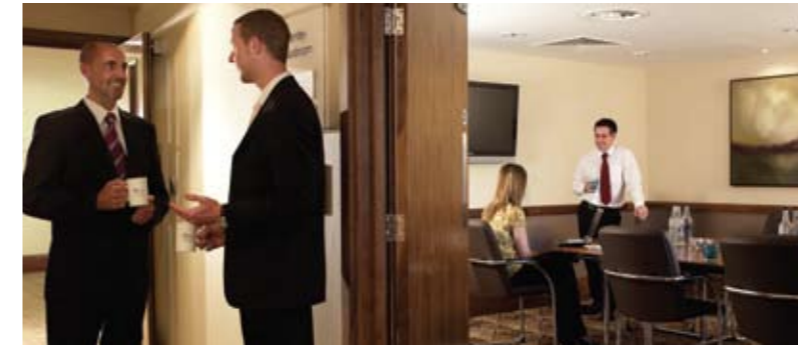

- 17 fully-equipped and flexible conference rooms.
- Space for 364 delegates in our Continental Suite.
- 117 beautifully-appointed and spacious bedrooms.
- Talented chefs and bespoke, mouth-watering menus.
- Free WiFi access for 24 hour delegates.
- Brand new £3.5 million leisure club and health spa.
- 500 complimentary car parking spaces.
- 3.5 glorious acres for team building exercises.
- Conveniently close to Crewe train station.
- Easily reached from Manchester and Liverpool airports.
- Ideally located just 2.5 miles from the M6.
- Exclusive use available here, please call for further information.





Old Hall Ground Floor

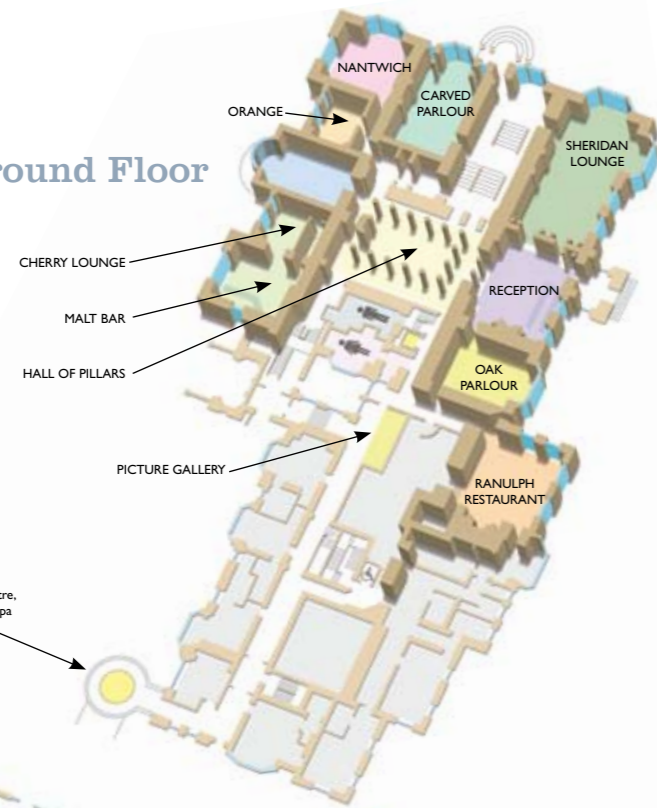

Old Hall First Floor

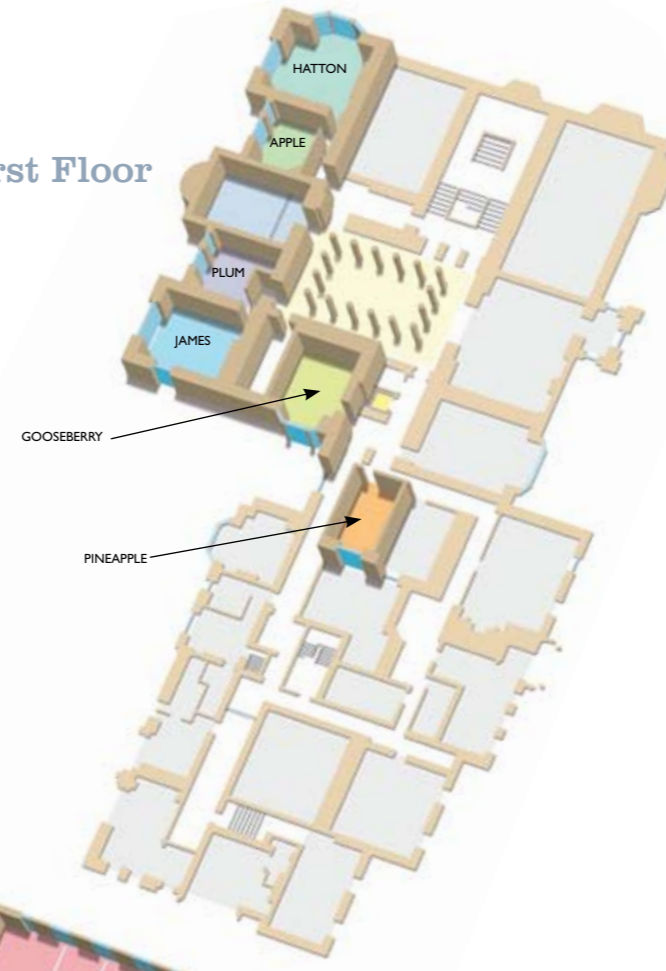

Old Hall Second Floor

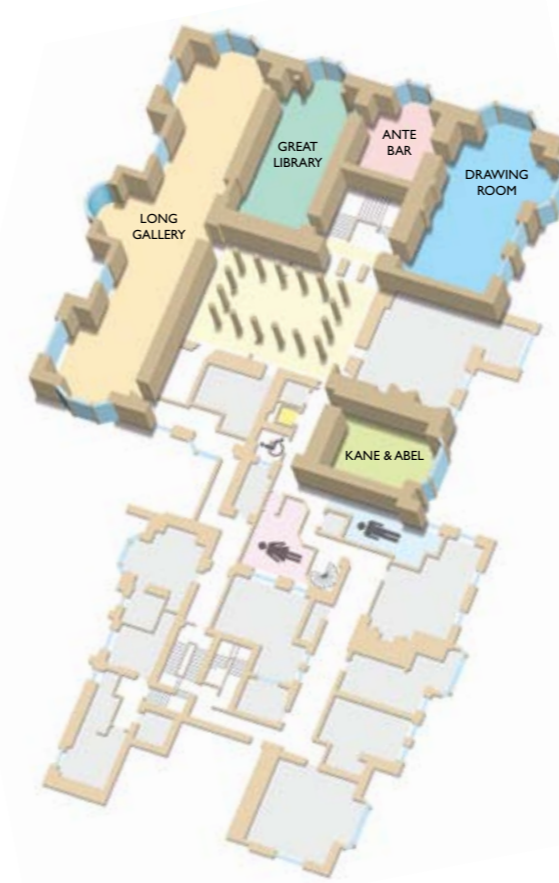

New Build Ground Floor



New Build First Floor



**KEY**

- BACK OF HOUSE
- PUBLIC ACCESS
- LIFTS
- WINDOWS
- STAIRS
- ♿ TOILETS

Room	Size m <sup>2</sup>	Length m	Width m	Height m	Cabaret	Theatre	Boardroom	U-Shape	Classroom	Banquet	Dinner Dance
Continental Suite	334	24	14	3.7	224	364	96	78	172	280	220
Continental 1	111	8.2	14	3.7	64	121	32	26	58	n/a	n/a
Continental 1 & 2	165	12	14	3.7	104	180	48	38	85	150	100
Continental 3 & 4	161	12	14	3.7	104	180	48	38	85	150	100
Continental 4	107	8.2	14	3.7	64	121	32	26	58	n/a	n/a
Arnage Suite	170	17.3	9.7	3.05	90	180	48	40	60	n/a	n/a
Arnage 1	55	5.6	9.7	3.05	32	60	16	12	20	n/a	n/a
Arnage 1 & 2	90	9.3	9.7	3.05	48	100	25	20	30	n/a	n/a
Arnage 3 & 4	80	8.1	9.7	3.05	40	90	20	18	28	n/a	n/a
Arnage 4	45	4.3	9.7	3.05	24	50	12	10	20	n/a	n/a
Azure	50	5.5	9.7	3.05	24	50	12	10	20	n/a	n/a
Bentley	37	7.4	4.9	3.05	15	40	10	8	18	n/a	n/a

Room	Size m <sup>2</sup>	Length m	Width m	Height m	Cabaret	Theatre	Boardroom	U-Shape	Classroom	Banquet	Dinner Dance
Long Gallery	249	30	8.3	4.71	100	260	100	80	110	180	150
Drawing Room	120	13.4	8.9	4.71	40	110	45	50	50	80	60
The Great Library	66.81	13.1	5.1	4.61	30	85	35	26	35	50	n/a
Carved Parlour	52.53	10.2	5.15	4.34	24	50	25	25	20	40	n/a
Oak Parlour	44.82	8.3	5.4	3.26	20	30	20	10	12	20	n/a
Kane & Abel	46.20	8.4	5.5	4.38	24	40	15	15	20	20	n/a
Hatton	40.95	6.5	6.3	2.8	15	26	16	15	12	n/a	n/a
Nantwich	34.56	6.4	5.4	2.45	20	25	16	15	12	20	n/a
James	35.64	6.6	5.4	3.26	n/a	n/a	8	n/a	n/a	n/a	n/a
Gooseberry	34.17	6.7	5.1	2.54	n/a	24	10	12	12	n/a	n/a
Pineapple	19.98	5.4	3.7	2.4	n/a	12	6	n/a	n/a	n/a	n/a
Apple	21.54	4.93	4.37	2.8	n/a	12	6	n/a	n/a	n/a	n/a
Orange	19.67	4.25	4.63	2.48	n/a	12	6	n/a	n/a	n/a	n/a

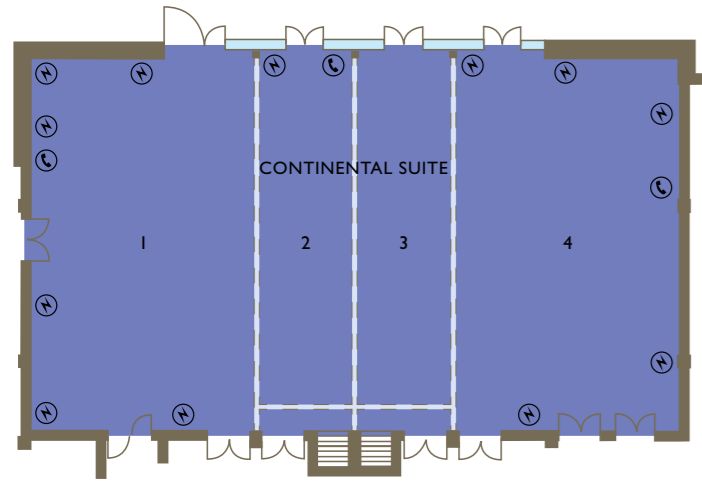

## CONTINENTAL SUITE (Ground Floor)

### CONTINENTAL SUITE

#### CAPACITIES

Maximum Capacity	364
Classroom	172
Boardroom	96
U-shape	78
Banquet	280
Dinner Dance	220
Theatre	364
Cabaret	224

#### DIMENSIONS (m)

Room Size	334m <sup>2</sup>
Length	24
Width	14
Height	3.7

#### FEATURES

Ground Floor  
Air Conditioning  
Natural Daylight

### CONTINENTAL SUITE 1

#### CAPACITIES

Maximum Capacity	121
Classroom	58
Boardroom	32
U-shape	26
Banquet	n/a
Dinner Dance	n/a
Theatre	121
Cabaret	64

#### DIMENSIONS (m)

Room Size	111m <sup>2</sup>
Length	8.2
Width	14
Height	3.7

#### FEATURES

Ground Floor  
Air Conditioning  
Natural Daylight

### CONTINENTAL SUITE 1&2

#### CAPACITIES

Maximum Capacity	180
Classroom	85
Boardroom	48
U-shape	38
Banquet	150
Dinner Dance	100
Theatre	180
Cabaret	104

#### DIMENSIONS (m)

Room Size	165m <sup>2</sup>
Length	12
Width	14
Height	3.7

#### FEATURES

Ground Floor  
Air Conditioning  
Natural Daylight

### CONTINENTAL SUITE 3&4

#### CAPACITIES

Maximum Capacity	180
Classroom	85
Boardroom	48
U-shape	38
Banquet	150
Dinner Dance	100
Theatre	180
Cabaret	104

#### DIMENSIONS (m)

Room Size	165m <sup>2</sup>
Length	12
Width	14
Height	3.7

#### FEATURES

Ground Floor  
Air Conditioning  
Natural Daylight

### CONTINENTAL SUITE 4

#### CAPACITIES

Maximum Capacity	121
Classroom	58
Boardroom	32
U-shape	26
Banquet	n/a
Dinner Dance	n/a
Theatre	121
Cabaret	64

#### DIMENSIONS (m)

Room Size	111m <sup>2</sup>
Length	8.2
Width	14
Height	3.7

#### FEATURES

Ground Floor  
Air Conditioning  
Natural Daylight

## DRAWING ROOM (Second Floor)

### CAPACITIES

Maximum Capacity	110
Classroom	50
Boardroom	45
U-shape	50
Banquet	80
Dinner Dance	60
Theatre	110
Cabaret	40

### DIMENSIONS (m)

Room Size	120m <sup>2</sup>
Length	13.4
Width	8.9
Height	4.71

### FEATURES

Second Floor  
Natural Daylight

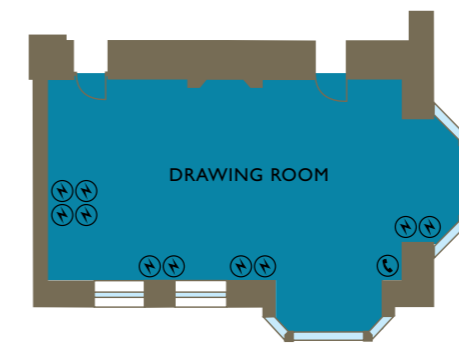

## GREAT LIBRARY (Second Floor)

### CAPACITIES

Maximum Capacity	80
Classroom	35
Boardroom	35
U-shape	26
Banquet	50
Dinner Dance	n/a
Theatre	85
Cabaret	30

### DIMENSIONS (m)

Room Size	66.81m <sup>2</sup>
Length	13.1
Width	5.1
Height	4.61

### FEATURES

Second Floor  
Natural Daylight

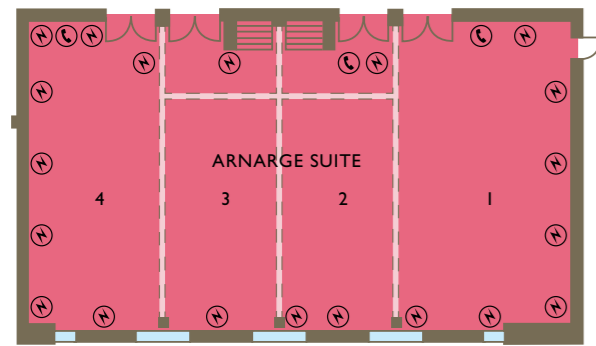
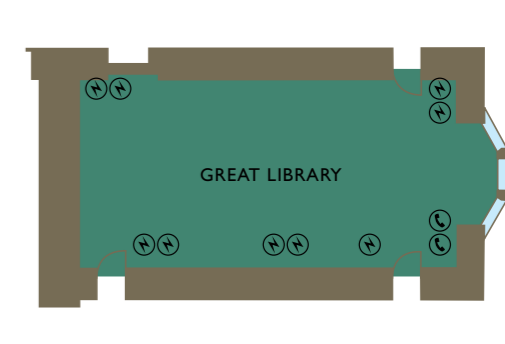

## ARNARGE SUITE (First Floor)

### ARNARGE SUITE

#### CAPACITIES

Maximum Capacity	180
Classroom	60
Boardroom	48
U-shape	40
Banquet	n/a
Dinner Dance	n/a
Theatre	180
Cabaret	90

#### DIMENSIONS (m)

Room Size	170m <sup>2</sup>
Length	17.3
Width	9.7
Height	3.05

#### FEATURES

First Floor  
Air Conditioning  
Natural Daylight

### ARNARGE SUITE 1

#### CAPACITIES

Maximum Capacity	60
Classroom	20
Boardroom	16
U-shape	12
Banquet	n/a
Dinner Dance	n/a
Theatre	60
Cabaret	32

#### DIMENSIONS (m)

Room Size	55m <sup>2</sup>
Length	5.6
Width	9.7
Height	3.05

#### FEATURES

First Floor  
Air Conditioning  
Natural Daylight

### ARNARGE SUITE 1&2

#### CAPACITIES

Maximum Capacity	100
Classroom	30
Boardroom	25
U-shape	20
Banquet	n/a
Dinner Dance	n/a
Theatre	100
Cabaret	48

#### DIMENSIONS (m)

Room Size	90m <sup>2</sup>
Length	9.3
Width	9.7
Height	3.05

#### FEATURES

First Floor  
Air Conditioning  
Natural Daylight

### ARNARGE SUITE 3&4

#### CAPACITIES

Maximum Capacity	90
Classroom	28
Boardroom	20
U-shape	18
Banquet	n/a
Dinner Dance	n/a
Theatre	90
Cabaret	40

#### DIMENSIONS (m)

Room Size	80m <sup>2</sup>
Length	8.1
Width	9.7
Height	3.05

#### FEATURES

First Floor  
Air Conditioning  
Natural Daylight

### ARNARGE SUITE 4

#### CAPACITIES

Maximum Capacity	50
Classroom	20
Boardroom	12
U-shape	10
Banquet	n/a
Dinner Dance	n/a
Theatre	50
Cabaret	24

#### DIMENSIONS (m)

Room Size	45m <sup>2</sup>
Length	4.3
Width	9.7
Height	3.05

#### FEATURES

First Floor  
Air Conditioning  
Natural Daylight

## LONG GALLERY (Second Floor)

### CAPACITIES

Maximum Capacity	260
Classroom	110
Boardroom	100
U-shape	80
Banquet	180
Dinner Dance	150
Theatre	260
Cabaret	100

### DIMENSIONS (m)

Room Size	249m <sup>2</sup>
Length	30
Width	8.3
Height	4.71

### FEATURES

Second Floor  
Natural Daylight

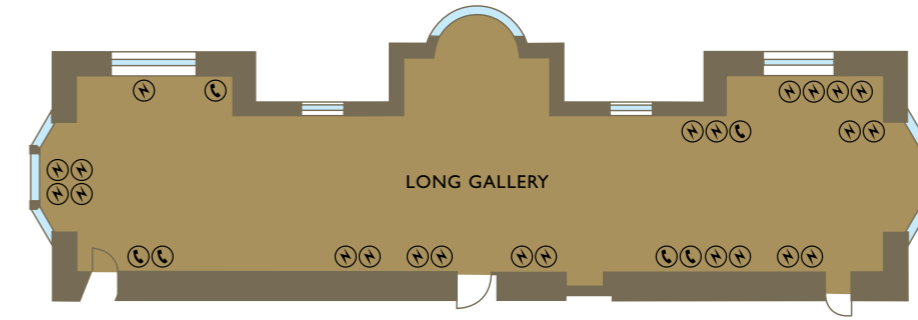

## KANE & ABEL (Second Floor)

### CAPACITIES

Maximum Capacity	40
Classroom	20
Boardroom	15
U-shape	15
Banquet	20
Dinner Dance	n/a
Theatre	40
Cabaret	24

### DIMENSIONS (m)

Room Size	46.20m <sup>2</sup>
Length	8.4
Width	5.5
Height	4.38

### FEATURES

Second Floor  
Natural Daylight

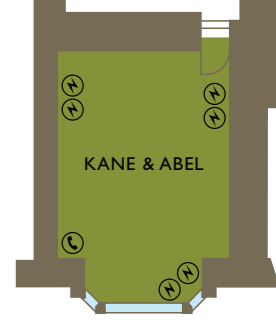

### KEY

☎ TELEPHONE POINT

⚡ POWER SUPPLY

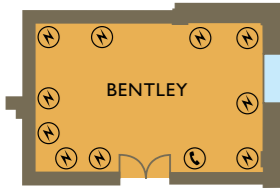

### BENTLEY

(First Floor)

#### CAPACITIES

Maximum Capacity	40
Classroom	18
Boardroom	10
U-shape	8
Banquet	n/a
Dinner Dance	n/a
Theatre	40
Cabaret	15

#### DIMENSIONS (m)

Room Size	37m <sup>2</sup>
Length	7.4
Width	4.9
Height	3.05

#### FEATURES

First Floor  
Air Conditioning  
Natural Daylight

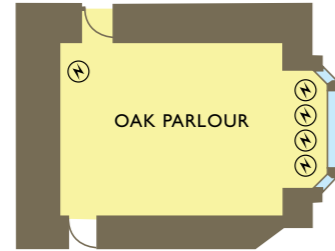

### OAK PARLOUR

(Ground Floor)

#### CAPACITIES

Maximum Capacity	30
Classroom	12
Boardroom	20
U-shape	10
Banquet	20
Dinner Dance	n/a
Theatre	30
Cabaret	20

#### DIMENSIONS (m)

Room Size	44.82m <sup>2</sup>
Length	8.3
Width	5.4
Height	3.26

#### FEATURES

Ground Floor  
Natural Daylight

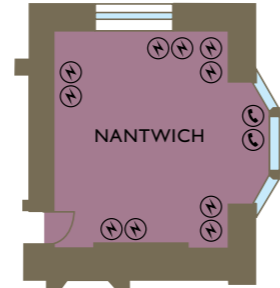

### NANTWICH

(Ground Floor)

#### CAPACITIES

Maximum Capacity	25
Classroom	12
Boardroom	16
U-shape	15
Banquet	20
Dinner Dance	n/a
Theatre	25
Cabaret	20

#### DIMENSIONS (m)

Room Size	34.56m <sup>2</sup>
Length	6.4
Width	5.4
Height	2.45

#### FEATURES

Ground Floor  
Natural Daylight

### JAMES

(First Floor)

#### CAPACITIES

Maximum Capacity	8
Classroom	n/a
Boardroom	8
U-shape	n/a
Banquet	n/a
Dinner Dance	n/a
Theatre	n/a
Cabaret	n/a

#### DIMENSIONS (m)

Room Size	35.64m <sup>2</sup>
Length	6.6
Width	5.4
Height	3.26

#### FEATURES

First Floor  
Natural Daylight

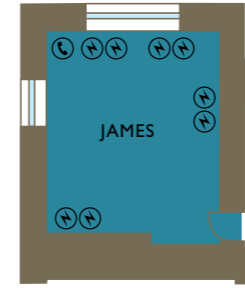

### HATTON

(First Floor)

#### CAPACITIES

Maximum Capacity	26
Classroom	12
Boardroom	16
U-shape	15
Banquet	n/a
Dinner Dance	n/a
Theatre	26
Cabaret	15

#### DIMENSIONS (m)

Room Size	40.95m <sup>2</sup>
Length	6.5
Width	6.3
Height	2.8

#### FEATURES

First Floor  
Natural Daylight

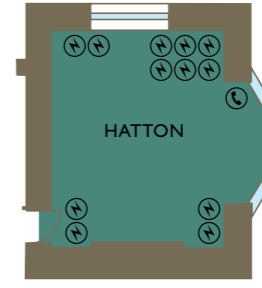

### GOOSEBERRY

(First Floor)

#### CAPACITIES

Maximum Capacity	24
Classroom	12
Boardroom	10
U-shape	12
Banquet	n/a
Dinner Dance	n/a
Theatre	24
Cabaret	n/a

#### DIMENSIONS (m)

Room Size	34.17m <sup>2</sup>
Length	6.7
Width	5.1
Height	2.54

#### FEATURES

First Floor  
Natural Daylight

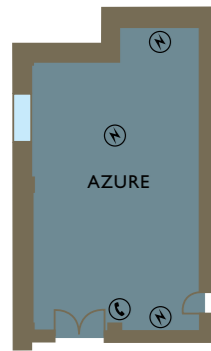

### AZURE

(First Floor)

#### CAPACITIES

Maximum Capacity	50
Classroom	20
Boardroom	12
U-shape	10
Banquet	n/a
Dinner Dance	n/a
Theatre	50
Cabaret	24

#### DIMENSIONS (m)

Room Size	45m <sup>2</sup>
Length	4.3
Width	9.7
Height	3.05

#### FEATURES

First Floor  
Air Conditioning  
Natural Daylight

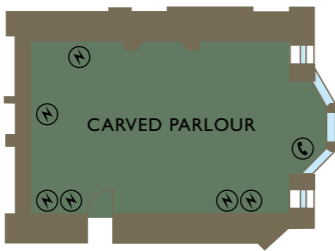

### CARVED PARLOUR

(Ground Floor)

#### CAPACITIES

Maximum Capacity	50
Classroom	20
Boardroom	25
U-shape	25
Banquet	40
Dinner Dance	n/a
Theatre	50
Cabaret	24

#### DIMENSIONS (m)

Room Size	52.53m <sup>2</sup>
Length	10.2
Width	5.15
Height	4.34

#### FEATURES

Ground Floor – Mezzanine  
Natural Daylight

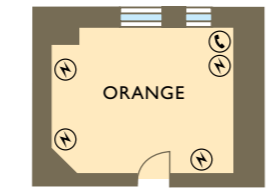

### ORANGE

(Ground Floor)

#### CAPACITIES

Maximum Capacity	12
Classroom	n/a
Boardroom	6
U-shape	n/a
Banquet	n/a
Dinner Dance	n/a
Theatre	12
Cabaret	n/a

#### DIMENSIONS (m)

Room Size	19.67m <sup>2</sup>
Length	4.25
Width	4.63
Height	2.48

#### FEATURES

Ground Floor  
Natural Daylight

### APPLE

(First Floor)

#### CAPACITIES

Maximum Capacity	12
Classroom	n/a
Boardroom	6
U-shape	n/a
Banquet	n/a
Dinner Dance	n/a
Theatre	12
Cabaret	n/a

#### DIMENSIONS (m)

Room Size	21.54m <sup>2</sup>
Length	4.93
Width	4.37
Height	2.8

#### FEATURES

First Floor  
Natural Daylight

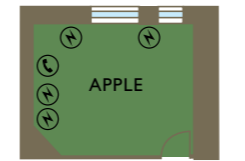

### PINEAPPLE

(First Floor)

#### CAPACITIES

Maximum Capacity	12
Classroom	n/a
Boardroom	6
U-shape	n/a
Banquet	n/a
Dinner Dance	n/a
Theatre	12
Cabaret	n/a

#### DIMENSIONS (m)

Room Size	19.98m <sup>2</sup>
Length	5.4
Width	3.7
Height	2.4

#### FEATURES

First Floor  
Natural Daylight

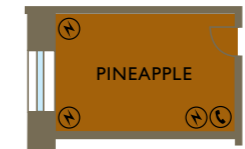

#### KEY

☎ TELEPHONE POINT

⚡ POWER SUPPLY





**3.5**  
million reasons to feel  
on top of the world.

Don't be fooled by Crewe Hall's historical ambience. All the luxuries of the modern world are here too. Following a £3.5 million investment, you'll find the latest spa baths, saunas, steam rooms, heated loungers, and a whole team of holistic therapists. Just what you need after a hard day's conferencing. And if you can't decide which treatment to have, feel free to try them all. Purely in the name of research of course. For those who prefer a more active approach to health, our Leisure Club has all the latest Technogym fitness machines, as well as a team of on-site fitness instructors to help you work out your workout. Then, if you need a lie down, where better than in one of our 117 luxurious and spacious bedrooms. With their stylish and sophisticated décor and blissfully comfortable furnishings you'll feel refreshed and relaxed in no time.



**364**

delegates saying 'mmmmm'.

As you might expect from such a spectacular hotel, the dining at Crewe Hall is awe-inspiring. And that's before you've even tasted a morsel. In the Ranulph restaurant, named after the man who built the Hall in 1615, you can feast your eyes on some truly extraordinary décor and furnishings. Such as the hand-painted wallpaper bearing the famous Crewe Hall crest. Then of course, there's the food. Our highly-experienced chefs have cooked up some truly inspiring menus for the restaurant and Brasserie with their unique culinary flair. The same talented team, you'll be pleased to know, prepare the food for our conferences and events too. Applying the same meticulous standards to every dish they serve. Sir Ranulph would be proud.





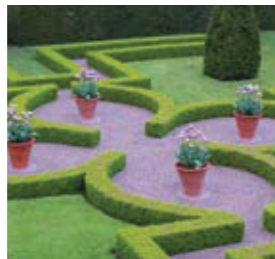

# 101

ways to take your mind off work.

When the business of the day is finally over, you won't be left twiddling with your tie. Because as well as 8 acres of glorious parkland and gardens to explore, an award-winning restaurant and brasserie, a luxurious health spa and a state-of-the-art leisure club, there is a whole world of distractions waiting for you outside our gates. Charming Cheshire villages, historic market towns, majestic castles, theatres, theme parks, steam railways, shopping centres, museums, even a motor racing circuit and an observatory. Of course, if you'd rather stay focused on your work and reflect on the day's events, you can always retreat to the peace and tranquillity of your beautifully-appointed bedroom



**Directions**  
**From Junction 16 of M6** Leave the M6 at Junction 16 and take the A500 towards Crewe. At the first roundabout take the last exit (A5020) sign posted Crewe. At the next roundabout take the first exit. The entrance to Crewe Hall will be found a few hundred yards along on the right hand side.

**BY RAIL**  
 Crewe Station – 1 mile.

**BY AIR**  
 Manchester – 29 miles.

**For reservations and general enquiries please call 01270 253333**  
**Email: [crewehallevents@QHotels.co.uk](mailto:crewehallevents@QHotels.co.uk)**  
**or visit [www.QHotels.co.uk](http://www.QHotels.co.uk)**

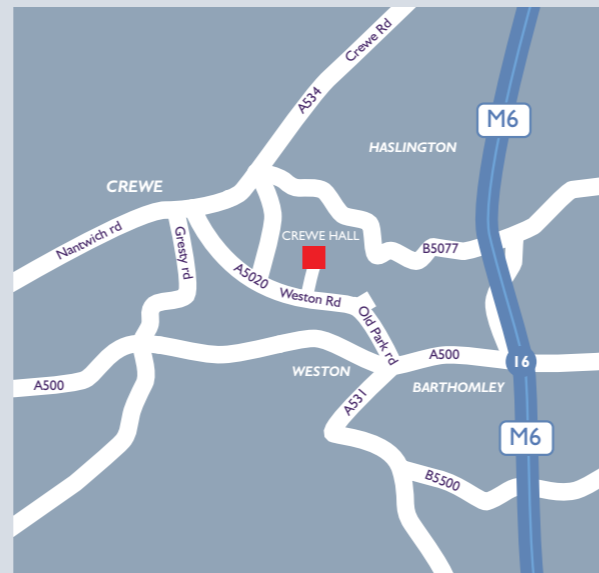

The gorgeousness doesn't end here. There are 20 other QHotels to visit across the country.

**The Westerwood Hotel & Golf Resort**  
 Nr Glasgow

**Aldwark Manor Golf & Spa Hotel**  
 York

**The Queens**  
 Leeds

**Tankersley Manor**  
 Tankersley, Nr Sheffield

**The Midland**  
 Manchester

**The Park Royal**  
 Stretton, Cheshire

**Forest Pines Hotel & Golf Resort**  
 North Lincolnshire

**The Nottingham Belfry**  
 Nottingham

**Telford Hotel & Golf Resort**  
 Shropshire

**Stratford Manor**  
 Stratford-upon-Avon

**The Stratford**  
 Stratford-upon-Avon

**Chesford Grange**  
 Kenilworth, Warwickshire

**Hellidon Lakes Golf & Spa Hotel**  
 Hellidon, Northamptonshire

**The Cambridge Belfry**  
 Cambourne, Cambridge

**The Cheltenham Chase Hotel**  
 Gloucestershire

**The Oxford Belfry**  
 Thame, Oxford

**The Hampshire Court Hotel**  
 Basingstoke, Hampshire

**Norton Park**  
 Winchester, Hampshire

**Bridgewood Manor**  
 Chatham, Kent

**Ashford International Hotel**  
 Ashford, Kent





Crewe Hall  
Weston Road  
Crewe  
Cheshire CW1 6UZ

**Tel: 01270 253333**  
**Fax: 01270 253322**

**Email: [crewehallevents@QHotels.co.uk](mailto:crewehallevents@QHotels.co.uk)**  
**[www.QHotels.co.uk](http://www.QHotels.co.uk)**

Galileo – QH24840  
Sabre – QH49965

Amadeus – QHXVCCWE  
Worldspan – QH41056

**QH**OTELS

You can take advantage of all we have to offer secure in the knowledge that everything we do at QHotels ensures a positive approach to our staff, our community and the environment.



Hotel Group of the Year  
2008 - 2009